

PARS KHAZAR

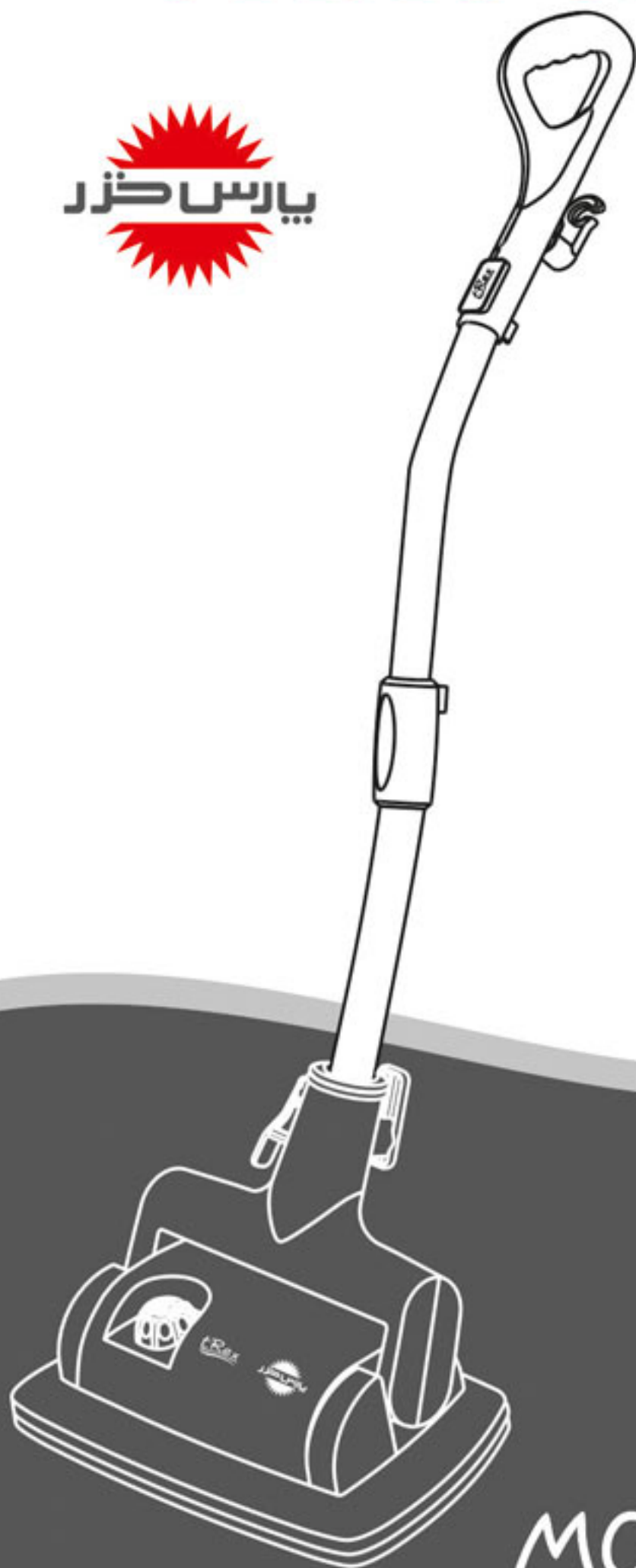

User's Manual
Steam cleaner



MODEL : *t.Rex*

Dear customer, thank you for purchasing this product, please read this instruction before your first using carefully.

Important safe guards

1. Make sure your electricity supply is 220V ~ 50Hz.
2. Keep the appliance out of the reach of children.
3. This appliance is intended for household use only.
4. Do not leave the steam cleaner unattended when plugged in.
5. Do not turn on the unit with empty water tank. Before every using, make sure the water tank is filled with water.
6. Before pouring water into water tank, turn off the unit and unplugged it.
7. Never use the steam cleaner without cleaning cloth.
8. Use only on flat, horizontal surfaces. Do not use on walls or windows.
9. Use only the attached cleaning cloths. Do not use irregular cleaning cloths.
10. Do not place the unit near any heated oven or hot surfaces. Keep the unit in cool and dry place.
11. Use the grounded type outlet.
12. Do not unplug by pulling on power cord. To unplug, grasp the plug not the cord.
13. Before plugging, turn off the unit.
14. Do not put any sharp objects into openings. Do not use with any opening blocked.
15. Before turning on the unit, make sure that the filling cap is closed.
16. Do not use the irregular extension cord.
17. Do not put hands or feet under the steam cleaner. Unit gets very hot.
18. Never direct steam towards people, animals, plants or electrical things.
19. Do not add cleaning solutions or any other chemicals into water tank.
20. Never leave the appliance in one spot on any surface for a long time.
21. Do not handle the cleaning cloth immediately after turning the unit off. Always, let it cool down before removing.

Parts Name:

1. Handle grip
2. Power cord
3. Metal tube
4. Filling cap
5. Main unit
6. ON/ OFF button
7. Power "ON" light (Green)
8. Empty light (Red)
9. Tube pivot
10. Upper cord holder
11. Lower cord holder
12. Cleaning cloth
13. Measured cup
14. Tube link

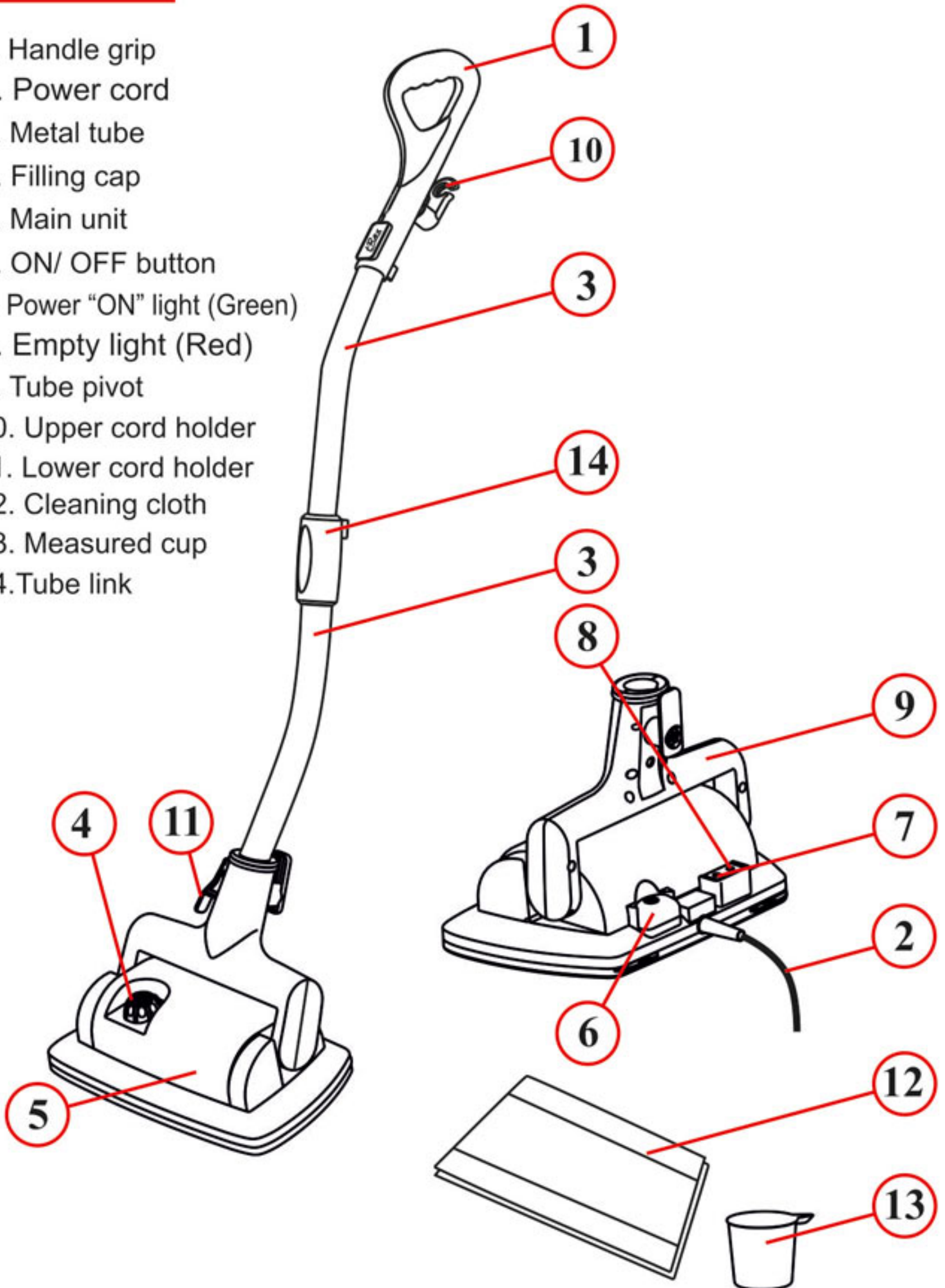

How to assemble and use

1. Remove all the parts from the packaging.
2. Assemble the handle grip and metal tubes properly :
3. Insert the handle into the tube pivot hole , as the metal button at the end of metal tube, to be fixed into tube pivot.
4. Place one of the cleaning cloths on the bottom of the steam cleaner. Make sure that the cleaning cloth is firmly attached to bottom of steam cleaner.(Fig.1)
5. Open the filling cap.
6. With the help of the measured cup, pour 1 cup of water into the main unit. Do not overfill. Replace filling cap when finished. (Fig.2)
7. Plug the unit into a standard 220 V outlet with earth connection.
8. Press the On/Off button to turn the green light on. It takes the unit approximately 2-3 minutes to heat up.
9. When there is no more water in the water tank, the empty light (Red) will go on.
10. To refill the water tank, turn the unit off and unplug from the electrical outlet and let the unit cool for 30 seconds. Then remove the filling cap and pour in the water. You do not have to wait for the unit to cool down before you refill.
11. When you have finished using the steam cleaner, turn the unit off and wait the steam cleaner cool down for approximately 5 minutes before removing the cleaning cloth from the base. Please note that the cleaning cloth gets very hot with the steam.
12. For parking the appliance, set the handle in vertical direction so that the tube pivot would be locked with main unit. For unlocking, just rotate the handle backward.

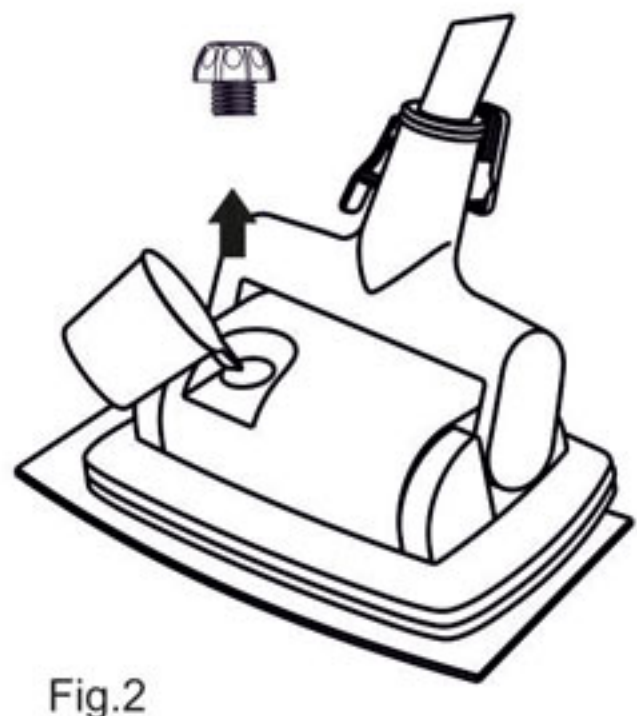

Care and maintenance:

1. Turn the unit off and unplug from electrical outlet.
2. Wrap power cord around upper & lower cord holders. (For releasing the cord, turn one of upper or lower cord holder.)
3. Let the unit cool for 5 minutes before removing the cleaning cloth and before emptying the water tank.
4. Always empty the water tank when you have finished using the unit.
5. Never leave the cleaning cloth on the main unit when you have finished using the steam cleaner. Always remove the cleaning cloth and wash in warm water with a mild detergent. Never use bleach or fabric softener when you clean the cleaning cloth.
6. The cleaning cloth can be washed in a washing machine and dried in a cloths dryer but on low heat. We recommend that you air dry for 24 hours.
7. Wipe the unit with a damp cloth to clean. Never immerse main unit in water or any other liquid.
8. In order to keep your steam cleaner in good condition, we recommend that you clean the water tank once a month to eliminate calcium deposits. Add 100 milliliters of water to the water tank and shake to loose any deposits. Remove the filling cap and immediately empty water.

Note: Do not use vinegar or other decalcifying substances in the steam cleaner water tank.

Helpful hints:

1. Always vacuum or sweep before steam cleaning.
2. A good amount of steam passes through the cleaning cloth. we recommend that the cleaning cloth be changed when it gets too wet.
3. To remove stubborn stains from vinyl or linoleum floors, pre- treat with a mild detergent and some water before using the steam cleaner.

Helpful hints:

If every below trouble happened, first, turn off the unit. Read every possible causes and use the possible solution. If the trouble didn't solve, refer to our authorized service agents.

Problem	Possible cause	Possible solution
Steam cleaner does not operate	Power cord is not firmly plugged into outlet.	Plug unit in firmly.
	The power cord, On/off button or inside wire set is damaged	Refer to our authorized service agents.
steam cleaner does not make steam	No water in water tank.	Add water to the water tank following instruction.
	The steam release holes have been blocked.	Refer to No.8 in care and maintenance section.
Steam cleaner leaves water on the floor.	Cleaning cloth is too wet.	Turn off unit, unplug from outlet and change cleaning cloth.
	Unit is not level on the floor.	Always keep the steam cleaner level and parallel to the floor.
Steam cleaner leaves white spot on floor.	Steam cleaner is left in one spot too long.	Remove the spot with few drops of white vinegar.
	Hard water.	Use distilled water.

Appliance specifications:

- 220-240V~, 800W, 50Hz
- Length of cord: 6 m
- Useful water tank capacity: 300ml
- Continuous working time: About 15 min